



RESIDENTIAL ESTATE AGENTS
PROPERTY LETTING & MANAGING AGENTS
VALUERS & PROPERTY CONSULTANTS
CHARTERED SURVEYORS

01722 336422
www.hwwhite.co.uk WEB



Tower Mews, St Marks Avenue

£1,500 PCM

15 Tower Mews, St Marks Avenue, Salisbury, Wilts, SP1 3DJ



Energy Efficiency Rating		Current	Potential
Very energy efficient - lower running costs			
(92 plus) A			
(81-91) B			
(69-80) C			
(55-68) D		65	71
(39-54) E			
(21-38) F			
(1-20) G			
Not energy efficient - higher running costs			
England & Wales		EU Directive 2002/91/EC	

The house has just been refurbished with a new kitchen, new carpets and decoration. Situated in an established development of similarly styled town houses built in the late 1980's, No 15 has a lower ground floor with an entrance hall, a utility room with sink and plumbing for washing machine etc and a cloakroom/wc along with a single, integral garage accessible from the utility room. Stairs up to the upper ground floor and a newly fitted, contemporary styled kitchen/breakfast room with an L-shape range of high and low level units incorporating a double electric oven, a gas hob and an integrated fridge/freezer and dishwasher. Spacious sitting room with double doors onto the rear garden at higher level than the front. Further stairs up to the top floor landing with an airing cupboard, bedroom one with an en-suite shower room, fitted wardrobes and its own small balcony. Double bedroom two and a second bathroom with a shower over the bath. The rear garden is enclosed with a patio area, lawn and pedestrian gate for rear access. The lower level front garden is open plan with paved parking for 2 cars in front of the garage. There is relatively new gas boiler for central heating and hot water and the property is double glazed giving an overall EPC rating of D. UNFURNISHED.

A Note From the Whites Letting Team

Thank you for considering Whites as your letting agent. As a proud member of the Royal Institution of Chartered Surveyors (RICS), we strive to uphold its core values by providing a fair, efficient, and transparent service to all prospective tenants. Below, we outline how we manage property inquiries and applications to help set expectations and guide you through the letting application process.

To start the process of inquiring about one of our properties, please click the 'Request Further Details/Info' button on the property listing.

If you are inquiring through Rightmove, you will be asked to fill out a short form, which will be sent directly to us. If you are using our website or On The Market, we will receive your contact information and get back to you as soon as possible with a brief questionnaire to complete.

Once we receive your completed form or questionnaire, your inquiry will be registered with the relevant Property Manager. Please note that only those who complete this step will be considered to have formally inquired about the property.

Due to the four for the best to up

of up to sur

Please be landlord, b

ith the

The availa

Ground Floor
Approx. 38.2 sq. metres (410.7 sq. feet)

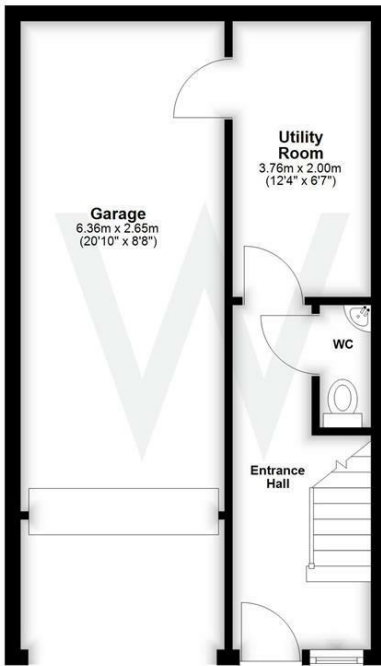

First Floor
Approx. 38.0 sq. metres (409.0 sq. feet)

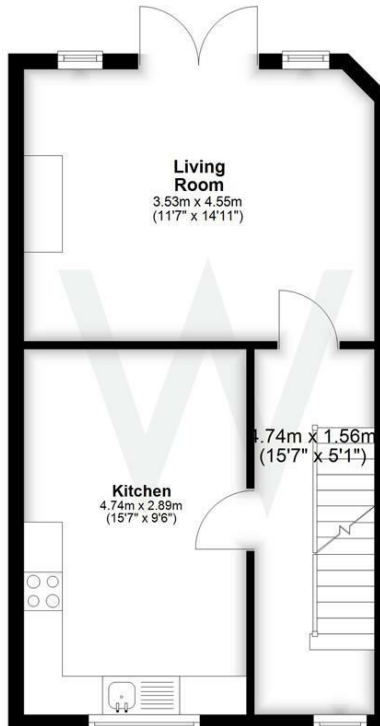

Second Floor
Approx. 37.9 sq. metres (407.7 sq. feet)



Total area: approx. 114.0 sq. metres (1227.4 sq. feet)



01722 336422

47 Castle Street, Salisbury SP1 3SP 01722 320600 FAX
residential-sales@hwwhite.co.uk E.MAIL www.hwwhite.co.uk WEB